



For Illustration Purpose Only

CHAMP HOIST

RACK and PINION DRIVE
PERSONNEL and
MATERIAL HOISTS

— TWIN CARS —

Models US-80-2R

—Standard Speed

US-8002-2R

—High Speed



Champion Hoist Co.



Champion

Rugged, American-Built Personnel/Material Hoists

For Construction

- Commercial High Rise
- Power Generation Plants
- Refineries and
Chemical Plants
- Shipyards

SPECIFICATIONS

	US-80-2R	US-8002-2R
Cage capacity, lbs.	8000 Per Car	8000 Per Car
Passenger, max.	40 Per Car	40 Per Car
Cage dimensions (inside), ft.-in.		
length	13'-0"	13'-0"
width	5'-7"	5'-7"
height	7'-4"	7'-4"
Cage speed, ft./min.	Min.-141 Low Speed Max.-148 High Speed	Min. 141-Max. 148 Min. 282-Max. 297
Electric service	62.5 KVA PER CAR 480 V-60Hz-3 PH	62.5 KVA PER CAR 480 V-60Hz-3 PH
Full load current amps.	70/Car	70/Car
Braking torque, ft./lbs.	2@-175/Car	2@-175/Car
Brakes	Electromechanical multiple disc	Electromechanical multiple disc
Total weight of base unit lbs.	33,500	41,000
Cage weight, lbs.	6,400 Ea.	6,400 Ea.
Weight of counterweight, lbs.	6,400 Ea.	9,600 Ea.
Tower height, max.	900	900
Tower sections, inches	60x28x56	60x28x56
Tower section weights, lbs.	485	485
Tower tie-in intervals, ft.	30	30
Counterweight wire rope 6x25XIP-IWRC	5/8-in.	3/4-in.
Counterweight wire rope length required	4 x tower ht. plus 40 ft.	4 x tower ht. plus 40 ft.
Traveling power cable (6/#6 Type W)	1 x tower ht. plus 30 ft.	1 x tower ht. plus 30 ft.
Stationary power cable (6/#4 Type W)	1 x tower ht. plus 30 ft.	1 x tower ht. plus 30 ft.

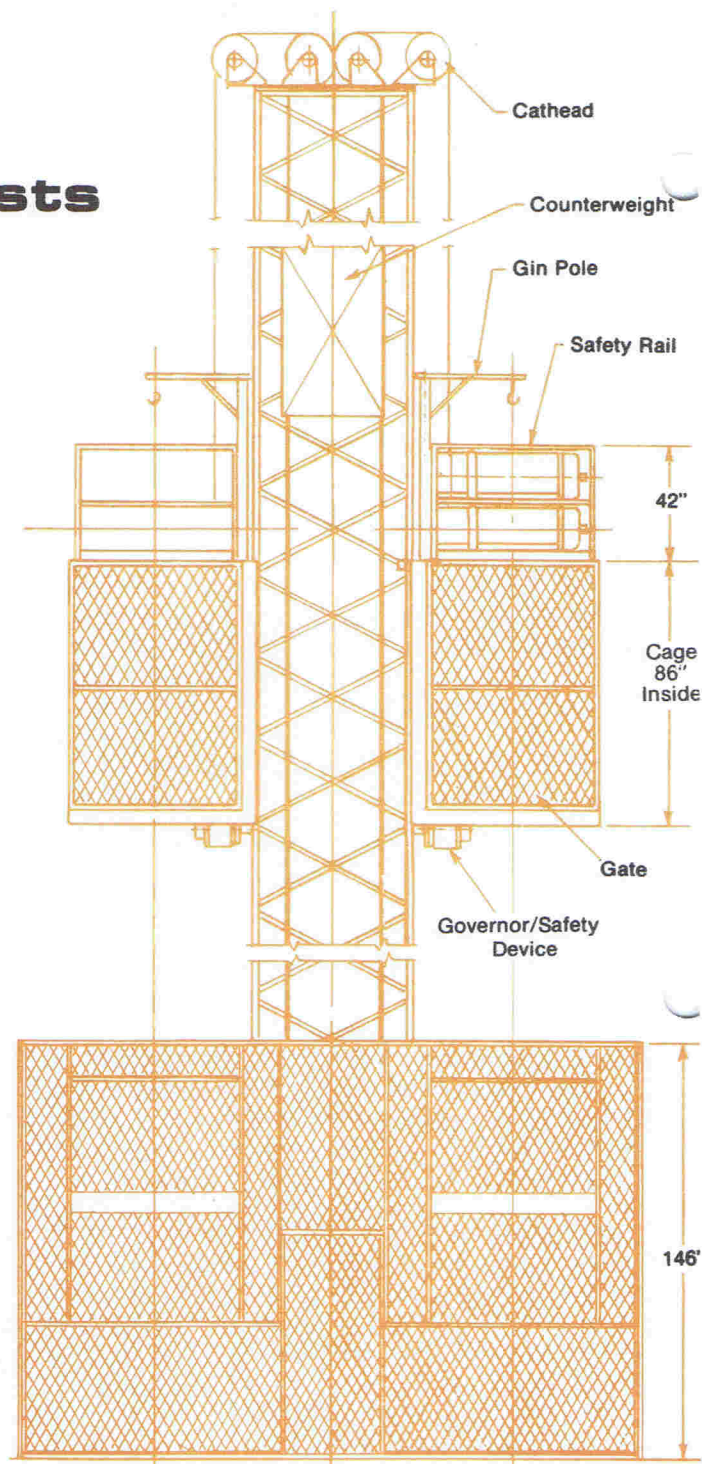

BASE UNIT

The following components a

- Completely assembled, enclosed cars with overspeed governor and safety brake, motor and all drive components
- Limit and control switches
- Buffer springs
- Counterweight frame with necessary weights

ADJUSTABLE TIE-IN ASSEMBLIES

The hoist tower is attached to the structure and stabilized with special telescoping tie-in assemblies, placed at 30 ft. intervals. Each tie-in requires only two mounting plates on the structure, either on a vertical (wall) or horizontal (floor) surface. Length is infinitely adjustable between the minimum and maximum specifications.

Champion Hoist Co.

TIE-IN SPECIFICATIONS

	(A) Length, in	(B) Distance between mounting plates, in	Car Gate/Structure Clearance, in	
			Wall Mount	Floor Mount
US - 80-2R	83"-105"	50"-55"	3"-25"	3"-13"
US - 8002-2R			3"-25"	3"-13"

FOR SERVICE CALL
Metro Elevator Company, Inc.
 P. O. BOX 11531
 INDIANAPOLIS, INDIANA 46201
 (317) 639-3417

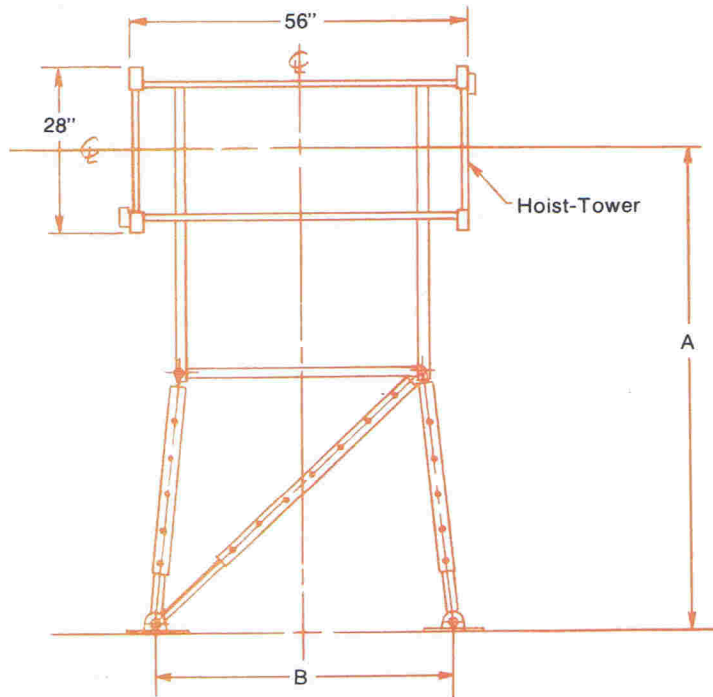

Description

Description	Part No.
<input type="checkbox"/> Tower section with twin rack, bolts and nuts	8400015-1
<input type="checkbox"/> Adjustable wall tie (Required every 30 Ft.)	8402021-1
<input type="checkbox"/> Counterweight wire rope, 5/8 in. dia. 6x25XIP-IWRC (US-80-2R)	530001-1
<input type="checkbox"/> CW wire rope 3/4 in. dia. 6x25XIP-IWRC (US-8002-2R)	530012-1
<input type="checkbox"/> Traveling electric power cable No. 6 AWG	510214-1
<input type="checkbox"/> Power Cord No. 4AWG	510217-1
<input type="checkbox"/> Building landing gate with mechanical latch and electrical interlock (less cable)	8300175-1
<input type="checkbox"/> Landing gate support jacks (2 required per gate)	8003152-1
<input type="checkbox"/> Base Anchor Bolts	8400757-1
<input type="checkbox"/> Gin Pole/Hand winch	8400080-1